

OCEA Classic 72



NAVAL ARCHITECT	JOUBERT/NIVELT	BUILDER	OCEA
LENGTH OVERALL	22.65 m	HULL	ALUMINIUM
BEAM	6.45 m	SUPERSTRUCTURE	ALUMINIUM
MAX DRAFT	1.85 m	DISPLACEMENT	85 tons
ENGINES	2 x 330 bhp	MAX SPEED	12.0 kts
RANGE @ 10 KNOTS	3 100 nm	CRUISING SPEED	10.0 kts
FUEL CAPACITY	18 000 lts	FRESH WATER CAPACITY	2 000 lts
GUESTS	6	CREW	2

OCEA Classic 72

> UPPER DECK

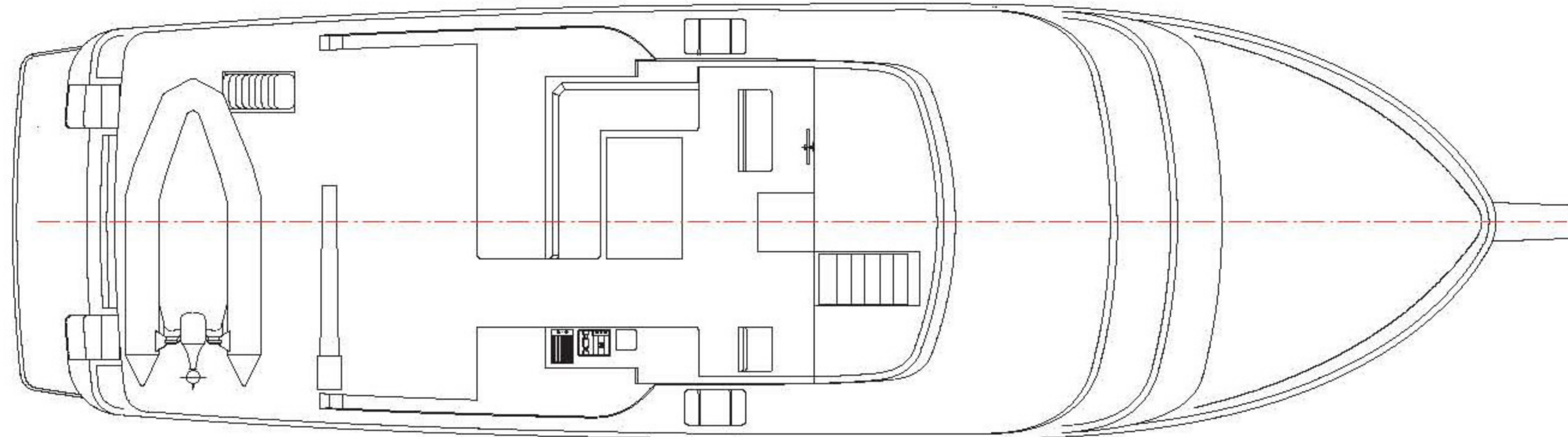

> MAIN DECK

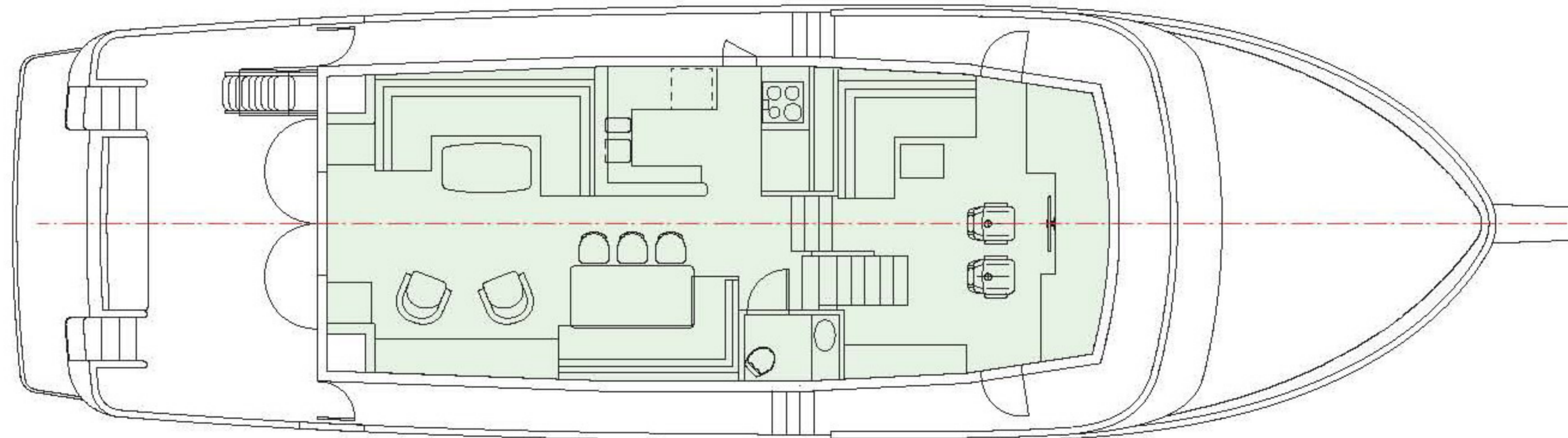

> LOWER DECK

